

Appendix A

Surrenden Area Residents Parking Scheme Initial Consultation Report

Background

The council has received a number of complaints from residents about parking issues within the Surrenden area.

At the Environment, Transport & Sustainability Committee in November 2019 it was agreed that residents and businesses in the Surrenden area would be written to in order to find out if there is general support for a resident parking scheme and if so, whether a full scheme or a light-touch scheme and what days of operation might be preferred.

If there is support for a residents parking scheme in the area, a further consultation with information about a detailed design will follow in June 2020. This will give residents a further opportunity to make a decision on whether they are happy with detailed proposals and to offer further comments.

Headline Findings

Support for a resident parking scheme:

- 618 (69.8%) of respondents support a residents parking scheme in the area.
- 268 (30.2%) of respondents do not support a residents parking scheme in the area

Full or Light-touch scheme

- 306 (36.8%) prefer a full scheme
- 525 (63.2%) prefer a light-touch scheme

Days of Operation

- 512 (62.1%) of respondents support a Monday to Friday scheme
- 312 (37.9%) of respondents support a Monday to Sunday scheme

Methodology

Brighton & Hove City Council Land and Property Gazetteer was used to provide 1662 property addresses in the proposed scheme boundary for the Surrenden Area. A questionnaire, frequently asked questions sheet and a prepaid envelope for reply was sent to each address. Respondents were also invited to complete the survey online via the council's Consultation Portal should they wish to. 670 (74.4%) responses received were by mail, 230 (25.5%) online and 1 response was received by email. The consultation ran from 7th January to 15th February 2020.

Results

901 valid responses¹ were received from within the proposed scheme boundary giving a response rate of 54%.

Q1 Would you like a parking scheme in your area? (response base 886²)

Yes		No		Total
Number	%	Number	%	
618	69.8	268	30.2	886

Results on a street by street basis were as follows:

Q2 Would you like a parking scheme in your area? (response base 901)

Street	Number properties mailed	Number responses	Response rate %	Yes		No	
				Number	%	Number	%
Bavant Road	17	12	70.6	10	83.3	2	16.7
Beacon Close	15	10	66.7	4	40.0	6	60.0
Cliveden Close	96	13	13.5	4	30.8	9	69.2
Cornwall Gardens	65	45	69.2	38	84.4	7	15.6
Ditchling Road	23	9	39.1	4	44.4	5	55.6
Draxmont Way	9	6	66.7	2	40.0	3	60.0
Fairlie Gardens	17	12	70.6	11	91.7	1	8.3
Fircroft Close	7	4	57.1	1	25.0	3	75.0
Friar Close	11	10	90.9	8	80.0	2	20.0
Friar Crescent	50	36	72.0	31	86.1	5	13.9
Friar Road	52	40	76.9	31	79.5	8	20.5
Friar Walk	8	6	75.0	3	50.0	3	50.0
Harrington Road	131	58	44.3	41	70.7	17	29.3

¹ 148 responses were removed from the analysis for the following reasons: 110 were duplicate cases, 27 were from outside the area, 6 were where no street was given and 5 were from incorrect or incomplete addresses.

² Response base = number of people answering this question

Street	Number properties mailed	Number responses	Response rate %	Yes		No	
				Number	%	Number	%
Harrington Villas	35	26	74.3	21	84.0	4	16.0
Hollingbury Copse	7	4	57.1	2	50.0	2	50.0
Holly Close	8	1	12.5	1	100	0	0
Knogle Road	34	20	58.8	13	65.0	7	35.0
Laine Close	37	21	56.8	12	60.0	8	40.0
London Road	212	42	19.8	23	56.1	18	43.9
Mulberry Close	12	10	83.3	7	70.0	3	30.0
Oak Close	2	0	0.0	0	0	0	0
Poplar Close	8	5	62.5	2	40.0	3	60.0
Preston Drove	19	16	84.2	11	68.8	5	31.3
Preston Road	50	8	16.0	2	25.0	6	75.0
Surrenden Close	15	13	86.7	6	50.0	6	50.0
Surrenden Crescent	71	56	78.9	44	83.0	9	17.0
Surrenden Holt	32	19	59.4	8	44.4	10	55.6
Surrenden Park	60	44	73.3	22	51.2	21	48.8
Surrenden Road	222	136	61.3	112	82.4	24	17.6
The Approach	12	5	41.7	2	40.0	3	60.0
Varndean Close	6	5	83.3	4	80.0	1	20.0
Varndean Drive	97	46	47.4	25	55.6	20	44.4
Varndean Gardens	42	36	95.2	26	76.5	8	23.5
Varndean Holt	17	14	82.4	10	71.4	4	28.6
Varndean Road	49	29	59.2	23	79.3	6	20.7
Walnut Close	13	9	69.2	6	66.7	3	33.3
Whittingehame Gardens	46	36	78.3	24	66.7	12	33.3
Withdean Crescent	53	39	73.6	24	63.2	14	36.8
Total	1662	901	54.2	618	69.8	268	30.2

Q If a parking scheme were to be introduced please tell us the options you would prefer? (Response base 831)

Option 1 – Full Scheme – Restricted parking 9am to 8pm

Option 2 – Light touch Scheme – two separate one hour periods during the day

Full Scheme 9am to 8pm		Two periods during the day eg 10am-11am and 2pm-3pm		Total
Number	%	Number	%	
306	36.8	525	63.2	831

Street	Full Scheme		Light-touch scheme	
	Number	%	Number	%
Bavant Road	5	45.5	6	54.5
Beacon Close	5	62.5	3	37.5
Cliveden Close	2	18.2	9	81.8
Cornwall Gardens	14	31.8	30	68.2
Ditchling Road	4	44.4	5	55.6
Draxmont Way	0	0	6	100
Fairlie Gardens	5	41.7	7	58.3
Fircroft Close	1	25.0	3	75.0
Friar Close	4	40.0	6	60.0
Friar Crescent	11	31.4	24	68.6
Friar Road	8	21.6	29	78.4
Friar Walk	1	16.7	5	83.3
Harrington Road	22	40.7	32	59.3
Harrington Villas	14	56.0	11	44.0
Hollingbury Copse	2	50.0	2	50.0
Holly Close	1	100	0	0
Knogle Road	9	47.4	10	52.6
Laine Close	6	31.6	13	68.4
London Road	13	37.1	22	62.9

Street	Full Scheme		Light-touch scheme	
	Number	%	Number	%
Mulberry Close	2	22.2	7	77.8
Oak Close	0	0	0	0
Poplar Close	1	25.0	3	75.0
Preston Drove	8	50.0	8	50.0
Preston Road	1	14.3	6	85.7
Surrenden Close	2	16.7	10	83.3
Surrenden Crescent	19	34.5	36	65.5
Surrenden Holt	4	25.0	12	75.0
Surrenden Park	7	17.5	33	82.5
Surrenden Road	71	54.2	60	45.8
The Approach	0	0	3	100
Vardean Close	3	60.0	2	40.0
Vardean Drive	9	23.7	29	76.3
Vardean Gardens	9	34.6	17	65.4
Vardean Holt	4	33.3	8	66.7
Vardean Road	13	44.8	16	55.2
Walnut Close	1	12.5	7	87.5
Whittingehame Gardens	15	44.1	19	55.9
Withdean Crescent	10	27.8	26	72.2
Total	306	36.8	525	63.2

Q If a parking scheme were to be introduced, please tell us your preference for either a Monday to Friday (5 day) or Monday to Sunday (7 day) scheme? (response base 824)

Monday to Friday		Monday to Sunday		Total
Number	%	Number	%	
512	62.1	312	37.9	824

Street	Monday to Friday		Monday to Sunday	
	Number	%	Number	%
Bavant Road	6	66.7	3	33.3
Beacon Close	4	50.0	4	50.0
Cliveden Close	9	81.8	2	18.2
Cornwall Gardens	33	75.0	11	25.0
Ditchling Road	5	71.4	2	28.6
Draxmont Way	6	100	0	0
Fairlie Gardens	8	66.7	4	33.3
Fircroft Close	3	75.0	1	25.0
Friar Close	5	50.0	5	50.0
Friar Crescent	25	73.5	9	26.5
Friar Road	25	67.6	12	32.4
Friar Walk	4	66.7	2	33.3
Harrington Road	39	69.6	17	30.4
Harrington Villas	9	37.5	15	62.5
Hollingbury Copse	2	50.0	2	50.0
Holly Close	0	0	1	100
Knogle Road	8	44.4	10	55.6
Laine Close	13	68.4	6	31.6
London Road	25	71.4	10	28.6
Mulberry Close	8	80.0	2	20.0
Oak Close	0	0	0	0
Poplar Close	3	75.0	1	25.0
Preston Drove	9	56.3	7	43.8
Preston Road	5	71.4	2	28.6
Surrenden Close	11	100	0	0
Surrenden Crescent	30	57.7	22	42.3
Surrenden Holt	9	60.0	6	40.0
Surrenden Park	29	70.7	12	29.3
Surrenden Road	59	45.4	71	54.6
The Approach	3	100	0	0
Varndean Close	3	60.0	2	40.0

Street	Monday to Friday		Monday to Sunday	
	Number	%	Number	%
Varndean Drive	28	71.8	11	28.2
Varndean Gardens	19	67.9	9	32.1
Varndean Holt	5	41.7	7	58.3
Varndean Road	19	65.5	10	34.5
Walnut Close	6	75.0	2	25.0
Whittingehame Gardens	12	36.4	21	63.6
Withdean Crescent	25	69.4	11	30.6
Total	512	62.1	312	37.9

Surrenden Area Residents Parking



Surrenden Area Residents Parking

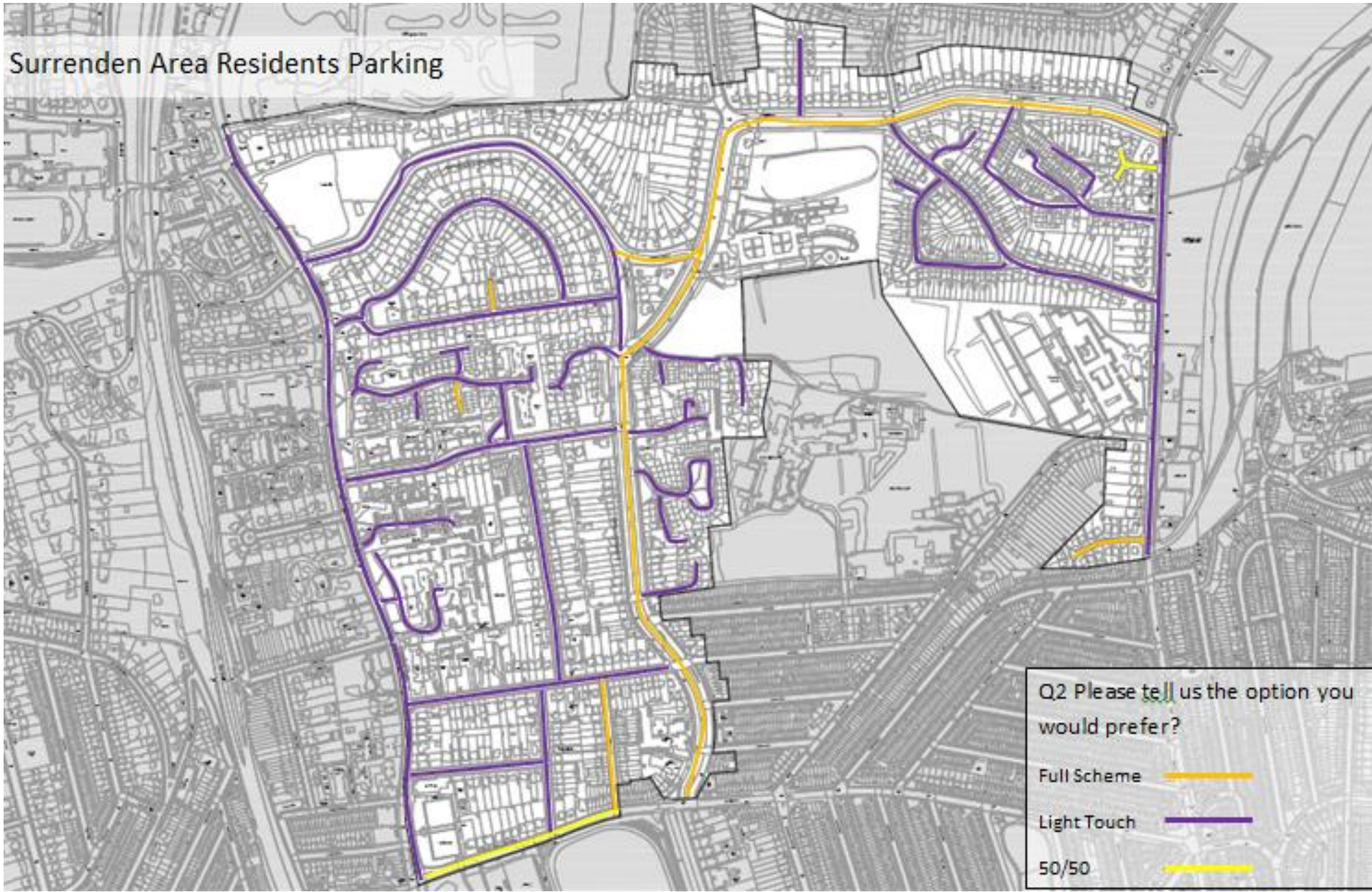

Q2 Please tell us the option you would prefer?

Full Scheme 

Light Touch 

50/50 

Surrenden Area Residents Parking

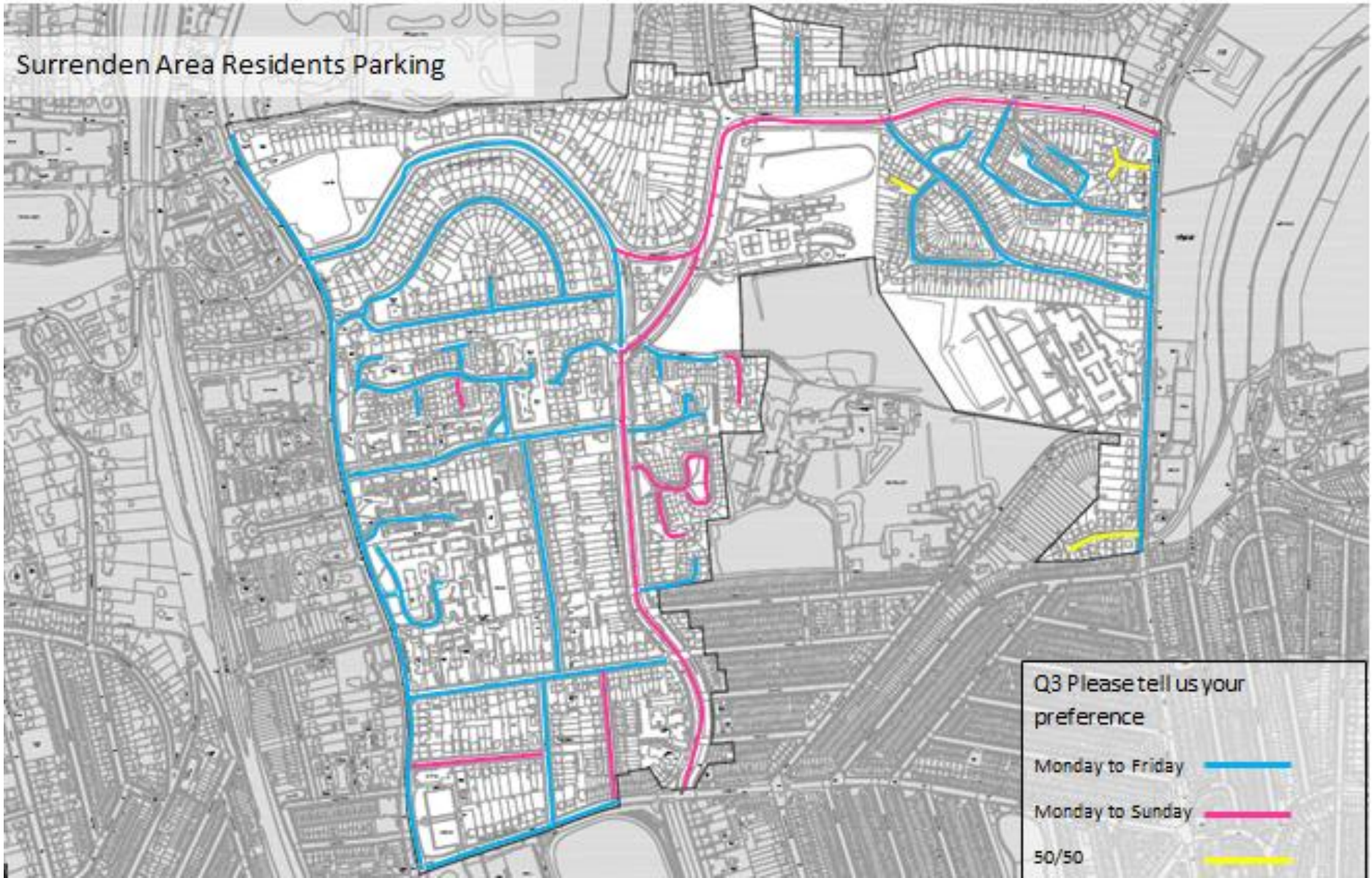

Demographic Information

Age	Number	%
18-24	9	1.3
25-34	46	6.6
35-44	98	14.0
45-54	168	24.0
55-64	156	22.3
65-74	128	18.3
75+	96	13.7
Total	701	100

Gender	Number	%
Male	356	45.1
Female	432	54.8
Non-Binary	1	0.1
Other	0	0
Total	789	100

Do you identify as the gender you were assigned at birth?	Number	%
Yes	741	99.1
No	7	0.9
Total	748	100

Disability	Number	%
Yes, a little	72	9.4
Yes, a lot	49	6.4
No	645	84.2
Total	766	100

Of those who answered “yes”, disabilities were as follows:

Please state the type of impairment which applies to you.	Number
Physical impairment	83
Sensory impairment	5
Learning disability/ difficulty	2
Long-standing illness	28
Mental health condition	9
Development condition	2
Autistic Spectrum	1
Other	12

Ethnic Origin		Number	%
White	White English/ Welsh/ Scottish/ Northern Irish/ British	688	89.1
	Irish	10	1.3
	Gypsy or Irish Traveller	0	0
	Any other white background	44	5.7
Asian or Asian British	Bangladeshi	1	0.1
	Indian	6	0.8
	Pakistani	0	0
	Chinese	1	0.1
	Any other Asian background	1	0.1
Black or Black British	African	2	0.3
	Caribbean	1	0.1
	Any other Black background	3	0.4
Mixed	Asian & White	6	0.8
	Black African & White	2	0.3
	Black Caribbean & White	1	0.1
	Any other mixed background	4	0.5
Any other ethnic group	Arab	1	0.1
	Any other ethnic group	1	0.1
Total		772	100

Sexual Orientation	Number	%
Bisexual	14	2.0
Gay Man	15	2.1
Heterosexual/ straight	661	93.0
Lesbian/ Gay Woman	11	1.5
Other	10	1.4
Total	711	100

Religious Belief	Number	%
I have no particular religion or belief	324	44.1
Buddhist	7	1.0
Christian	286	38.9
Hindu	2	0.3
Jain	0	0
Jewish	6	0.8
Muslim	3	0.4
Pagan	2	0.3
Sikh	1	0.1
Agnostic	22	3.0
Atheist	62	8.4
Other	10	1.4
Other philosophical belief	10	1.4
Total	735	100

Are you a carer	Number	%
Yes	83	10.7
No	695	89.3
Total	778	100

If yes, do you care for a:	Number
Parent	43
Partner or Spouse	17
Child with special needs	15
Friend	2
Other family member	9
Other	3

Armed Forces	Yes		No	
	Number	%	Number	%
Are you currently serving in the UK armed forces?	1	0.1	718	99.9
Have you ever served in the UK armed forces?	31	4.4	675	95.6
Are you a member of a current or former serviceman or woman's immediate family/ household?	15	2.1	693	97.9

