



Robert Bray Associates

Sustainable Drainage Consultants
Landscape Architects

Wild Park Brighton

SuDS Concepts: The Keep Balancing Pond

231

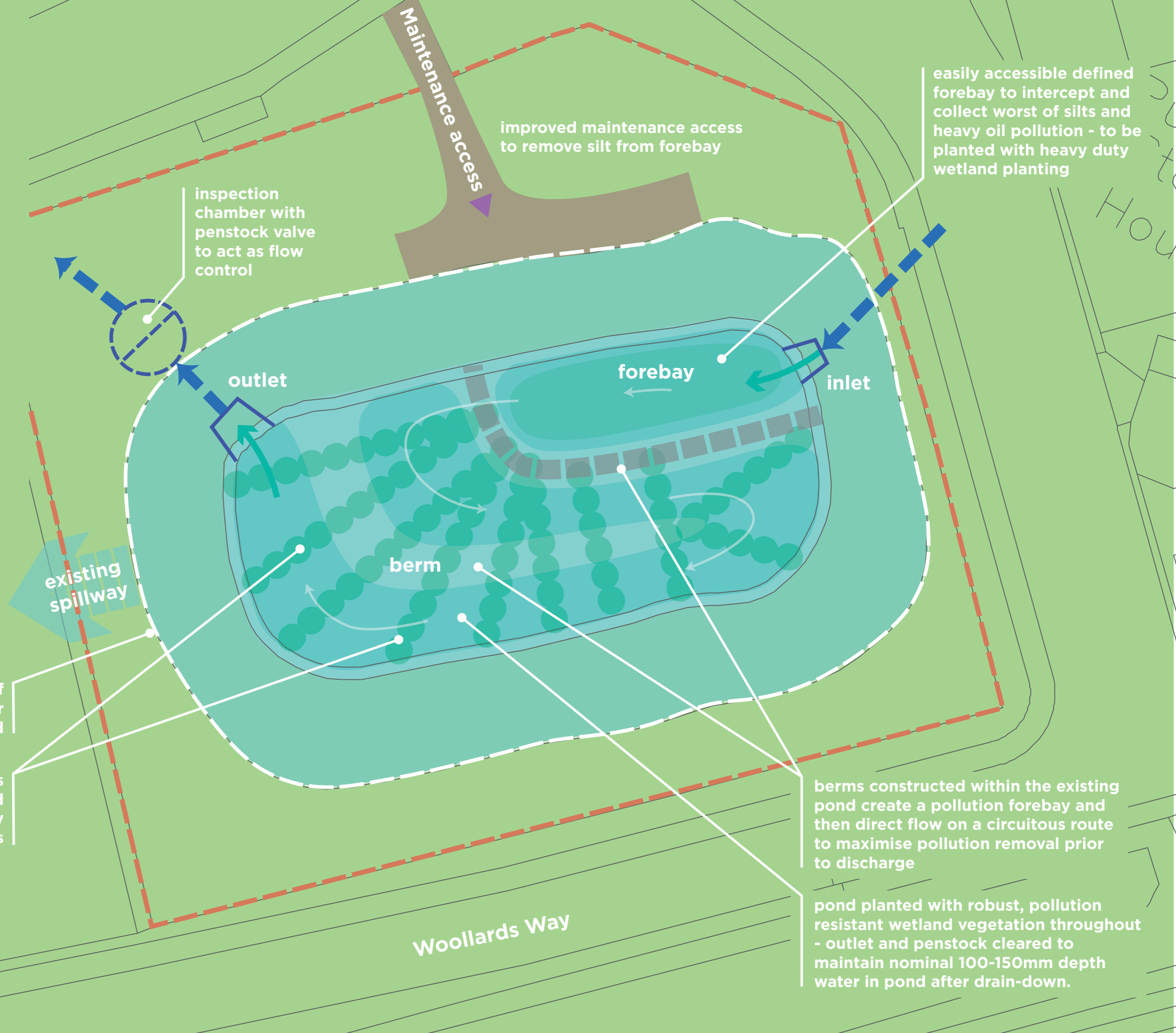

easily accessible defined forebay to intercept and collect worst of silts and heavy oil pollution - to be planted with heavy duty wetland planting

improved maintenance access to remove silt from forebay

inspection chamber with penstock valve to act as flow control

outlet

forebay

inlet

berm

existing spillway

condition of pond liner checked

floating wetland booms provide enhanced treatment - especially when balancing pond fills

berms constructed within the existing pond create a pollution forebay and then direct flow on a circuitous route to maximise pollution removal prior to discharge

pond planted with robust, pollution resistant wetland vegetation throughout - outlet and penstock cleared to maintain nominal 100-150mm depth water in pond after drain-down.

Woollards Way



Robert Bray
Associates

Sustainable Drainage Consultants
Landscape Architects

Wild Park Brighton

SuDS Concepts Option 1

basins planted with a range of damp meadow seed mixed and plug plants with adjoining grassland maintained as biodiverse meadow

plant and habitat diversity will naturally grade from damp tolerant species at upstream basins to drier conditions in lower basins

the first two basins are treatment basins prioritising pollution removal and are lined to protect against infiltration until the flow is sufficiently cleaned

new lined wetland planted swale conveys flow from intercepted sewer pipe to the treatment and infiltration basins



subsequent basins are unlined and allow blanket infiltration through the biodiverse damp meadow vegetated surface

additional basin provides additional attenuation in case of exceedance

path sweeps back to meet bus-stop

potential discharge to existing soakaways if deemed appropriate

alternative parkland path route connects to existing pavement



Robert Bray
Associates

Sustainable Drainage Consultants
Landscape Architects

Wild Park Brighton

SuDS Concepts: Option 2

233

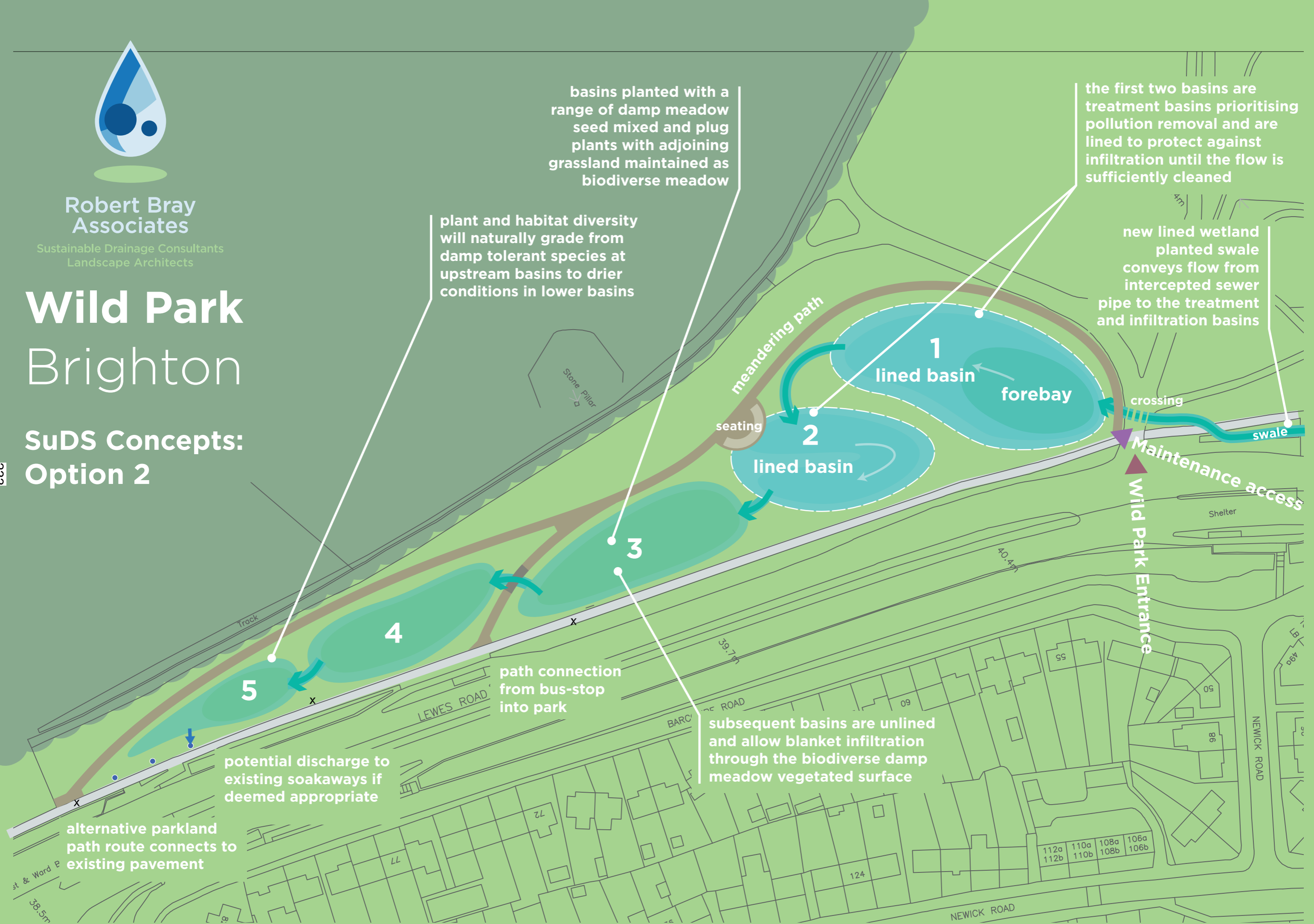

basins planted with a range of damp meadow seed mixed and plug plants with adjoining grassland maintained as biodiverse meadow

plant and habitat diversity will naturally grade from damp tolerant species at upstream basins to drier conditions in lower basins

the first two basins are treatment basins prioritising pollution removal and are lined to protect against infiltration until the flow is sufficiently cleaned

new lined wetland planted swale conveys flow from intercepted sewer pipe to the treatment and infiltration basins

meandering path

seating

1 lined basin

forebay

2 lined basin

crossing

swale

Maintenance access

Wild Park Entrance

Shelter

3

4

5

path connection from bus-stop into park

subsequent basins are unlined and allow blanket infiltration through the biodiverse damp meadow vegetated surface

potential discharge to existing soakaways if deemed appropriate

alternative parkland path route connects to existing pavement

st & Ward E
38.5m

NEWICK ROAD

